

FARRIS, HANSEN & ASSOCIATES, INC.

ENGINEERING – ARCHITECTURE – SURVEYING
7 RIDGWAY COURT – P.O. BOX 437 – ELKHORN, WISCONSIN 53121
PHONE: (262) 723-2098 FAX: (262) 723-5886

PLAT OF SURVEY – TITLE SURVEY

LOT 1 OF CSM 5090
LOCATED IN PART OF THE SE 1/4 OF THE NE 1/4 OF
SECTION 36, TOWN 2 NORTH, RANGE 15 EAST,
TOWN OF DARIEN, WALWORTH COUNTY, WISCONSIN

– WORK ORDERED BY –
JORDAN STRUCK
N1806 HIGHWAY 12
FORT ATKINSON, WI 53158

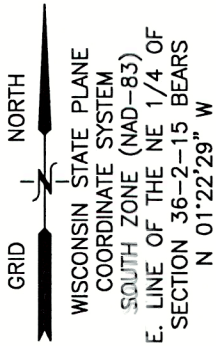

The Land is described as follows:

Certified Survey Map No. 5090 as recorded in the Office of the Register of Deeds for Walworth County, Wisconsin, on March 15, 2023, as Document No. 1076220, part of the Southeast 1/4 of the Northeast 1/4 of Section 36, Township 2 North, Range 15 East, Town of Darien, Walworth County, Wisconsin.

Tax ID No. Part of BD 3600001A (2022)
BA509000001 (2023)

LEGAL DESCRIPTION OF RECORD PER FIRST AMERICAN TITLE INSURANCE COMPANY,
POLICY NUMBER: TA-333501

NOTE: A COMPLETE SOIL AND SITE EVALUATION MAY NOT HAVE BEEN CONDUCTED ON EACH LOT OR PARCEL. NO STRUCTURE SHALL BE ERECTED ON ANY LOT(S) OR PARCEL(S) UNLESS THE REQUIREMENTS OF SPS 383, WISCONSIN ADMINISTRATIVE CODE, AND THE WALWORTH COUNTY ORDINANCES HAVE BEEN MET. HOLDING TANK USE IS PROHIBITED FOR NEW CONSTRUCTION ON ANY LOT(S) OR PARCEL(S).

UNPLATTED LANDS
OWNED BY SUBDIVIDER
115 ACRES ± REMAIN

100' WIDE
ACCESS AND
UTILITY
EASEMENT
PER
DOCUMENT
NO. 1073027

ELM RIDGE ROAD
{66' WIDE R.O.W.}

CENTER
36-2-15
{217,588.50 N.}
{2,327,087.01 E.}

2199.37'

N 87°19'02" E 450.12'

LOT 1

217,801 S.F.
(5.00 ACRES)

N 01°22'29" W 484.00'

2161.19'

NE CORNER
36-2-15
{220,356.94 N.}
{2,329,670.21 E.}

N 01°22'29" W 2645.19'
{2645.28'}

LOT 30 OF
DUTCH
MEADOWS
SUBDIVISION

{S 01°22'32" E}
S 01°22'29" E 484.00'

E. 1/4 CORNER
36-2-15
{217,712.45 N.}
{2,329,733.67 E.}

S 87°19'02" W 2649.49'
{S 87°19'07" W 2649.59'}

UNPLATTED LANDS

UNPLATTED LANDS

LEGEND

- = FOUND CONCRETE COUNTY MONUMENT WITH BRASS CAP
- = SET IRON REBAR STAKE, 3/4" x 18" x 1.13 lbs/ft
- {XXX} = RECORDED AS
- ⊕ = SOIL TEST BORING LOCATED

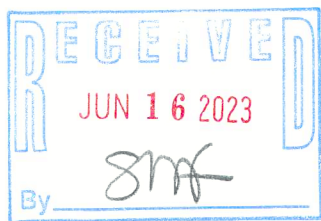

NOTE: COPIES OF THIS MAP TO WHICH THE FOLLOWING CERTIFICATE WILL APPLY SHOW THE SURVEYOR'S ORIGINAL SEAL AND SIGNATURE IN RED INK. COPIES BY ANY OTHER MEANS MAY HAVE ALTERATIONS WHICH DO NOT REPRESENT THE SURVEYOR'S WORK PRODUCT.

I HEREBY CERTIFY THAT THE ABOVE DESCRIBED PROPERTY HAS BEEN SURVEYED UNDER MY DIRECTION AND THAT THE ABOVE MAP IS A TRUE REPRESENTATION THEREOF AND SHOWS THE SIZE AND LOCATION OF THE PROPERTY, ITS EXTERIOR BOUNDARIES, THE LOCATION OF ALL VISIBLE STRUCTURES, AND DIMENSIONS OF ALL PRINCIPLE BUILDINGS THEREON, BOUNDARY FENCES, APPARENT EASEMENTS, ROADWAYS, AND VISIBLE ENCROACHMENTS, IF ANY. THIS SURVEY IS MADE FOR THE USE OF THE PRESENT OWNERS OF THE PROPERTY, AND ALSO THOSE WHO PURCHASE, MORTGAGE, OR GUARANTEE THE TITLE THERETO WITHIN ONE YEAR FROM THE DATE HEREOF.

DATED: 4/10/2023

[signature]
CHRISTOPHER A. HODGES

P.L.S. 2760

10763
DATE: 4/10/2023
SHEET 1 OF 1

120 60 0 120
MAP SCALE IN FEET – ORIGINAL 1"=120'